

Parameters

Electrical parameters	
Working Voltage	21~30V DC
Control IO	KNX TP1 control port
Static Current	< 12mA
User Controls	Manual Over-ride switch for each button
Environmental Conditions	
Working temperature	-5°C ~ 45°C
Working relative Humidity	Up to 90%
Storage temperature	-20°C~+60°C
Storage relative humidity	Up to 93%
Approved	
CE, RoHS	
KNX	
Product information	
Dimensions	86×116.5×10.5 (mm) (Normal) 96×126.5×10.5 (mm) (XL)
Net weight	132.6g (Normal) 163.4g (XL)
Housing Material	Glass, PC, aluminum, ABS
IP rating	IP 20

Important Notes

- **Special Programming** – This device is designed for professional KNX installation. It can only be programmed by ETS software.
- **Cable Connections** – Do not get wrong connection for Black and Red wires
- **Mounting Location** –When installed outdoors, pay attention to waterproof.
- **Voltage** - The input of voltage must be between 21-30VDC
- It must work with M/PCI.3-A.

Installation

- Steps** Mount the device inside an approved electrical enclosure.
- Connect KNX /EIB cables. Ensure correct cable type and lengths.
 - Re-check all terminations prior to energizing.
 - Energize supply and KNX bus. KNX bus shall be between 21-30V DC.

Overview



M/TBP2.1-A2-46

M/TBP4.1-A2-46

M/TBP6.1-A2-46

HDL KNX / EIB multifunction touch button panel are in full compliance with the KNX association protocol. The touch panels have touch keys and background lights. KNX Smart 2,4,6 Buttons wall touch switch Panel.

Functions

- It has Built-in mini infrared receiver, with the function of sending the variety data points at the same time that can simultaneously control many different types of KNX equipment.
- The simple to use Multi control for:
 - Switch control, Dimming, Scene control, Sequence control,
 - Curtain control, Shutter control,
 - Button Lock, Button Trigger,
 - String control, Flexible control,
 - Percentage control,
 - Combination control,
 - 1 bytes control, 2 bytes control, 4 bytes control bytes (String) control.
- Keep pressing the first and last button together for 2 seconds, the button will flash and database can be downloaded from ETS to the device.

Layout

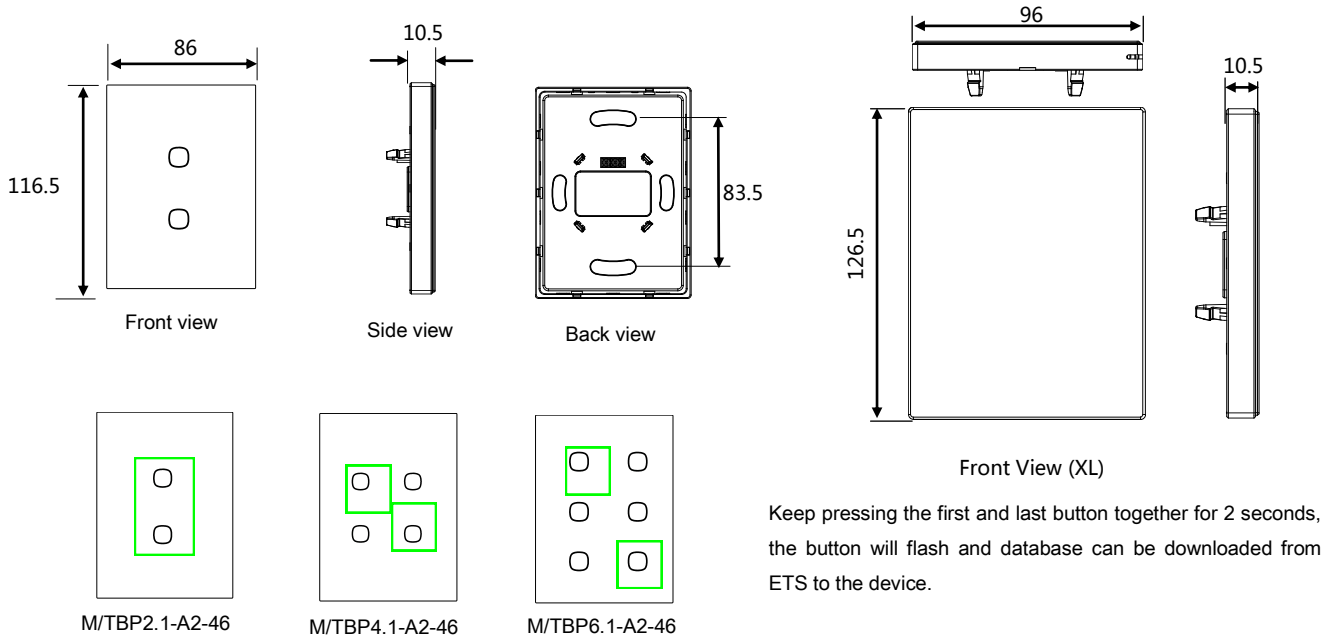

Installation

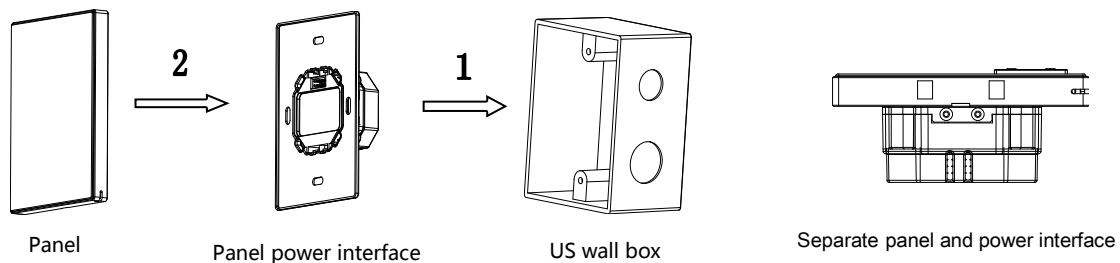

Installation: Hold the edge of panel insert the power interface module vertically.

Split: Panel and panel power interface by magnetic suction, you can split them apart directly.

Safety Precautions



- Installation Position:
- Do not make wrong connection on Bus interface, it will damage the Bus interface this module
- Do not get AC220V voltage into KNX/EIB Bus wire , it will damage all of devices in system
- Assure a good ventilation circumstances
- Rain, liquid, and aggressive gas are not allowed to close to it

Package Contents

- Datasheet*1 / panel *1