

## Parameters

Electrical parameters	
Working Voltage	21~30V DC
Control IO	KNX TP1 control port
Bus Current	< 12mA
User Controls	Manual Over-ride switch for each button
Environmental Conditions	
Working temperature	-5°C ~ 45°C
Working relative Humidity	Up to 90%
Storage temperature	-20°C~+60°C
Storage relative humidity	Up to 93%
Approved	
CE, RoHS	
KNX	
Product information	
Dimensions	86mm×86mm×10.5mm
Net weight	107.4g
Housing Material	Glass, PC, aluminum
IP rating	IP 20

## Important Notes

- **Special Programming** – This device is designed for professional KNX installation. It can only be programmed by ETS software.
- **Cable Connections** – Do not get wrong connection for Black and Red wires
- **Mounting Location** –When installed outdoors, pay attention to waterproof.
- **Voltage** - The input of voltage must be between 21 -30VDC

## Installation Steps

- Mount the device inside an approved electrical enclosure.
- Connect KNX /EIB cables. Ensure correct cable type and lengths.
- Re-check all terminations prior to energizing.
- Energize supply and KNX bus. KNX bus shall be between 21-30Vdc.

## Overview



M/TBP2.1-A2-48



M/TBP4.1-A2-48

HDL KNX / EIB multifunction Panel controller are in full compliance with European safety standards and the KNX association protocol. The touch panels have touch keys and background lights. KNX Smart 2 , 4 Buttons wall touch switch Panel.

## Functions

- It has Built-in mini infrared receiver, with the function of sending the variety data points at the same time that can simultaneously control many different types of KNX equipment.
- The simple to use Multi control for:
  - Switch control, Dimming, Scene control, Sequence control,
  - Curtain control, Shutter control,
  - Button Lock, Button Trigger,
  - String control, Flexible control,
  - Percentage control,
  - Combination control, golden metal
  - 1 bytes control,2 bytes control,4 bytes control bytes (String) control.
- Keep pressing the first and last button together for 2 seconds, the button will flash and database can be downloaded from ETS to the device. M/TBP1 .1 should press the button for 20 seconds.

**Layout**

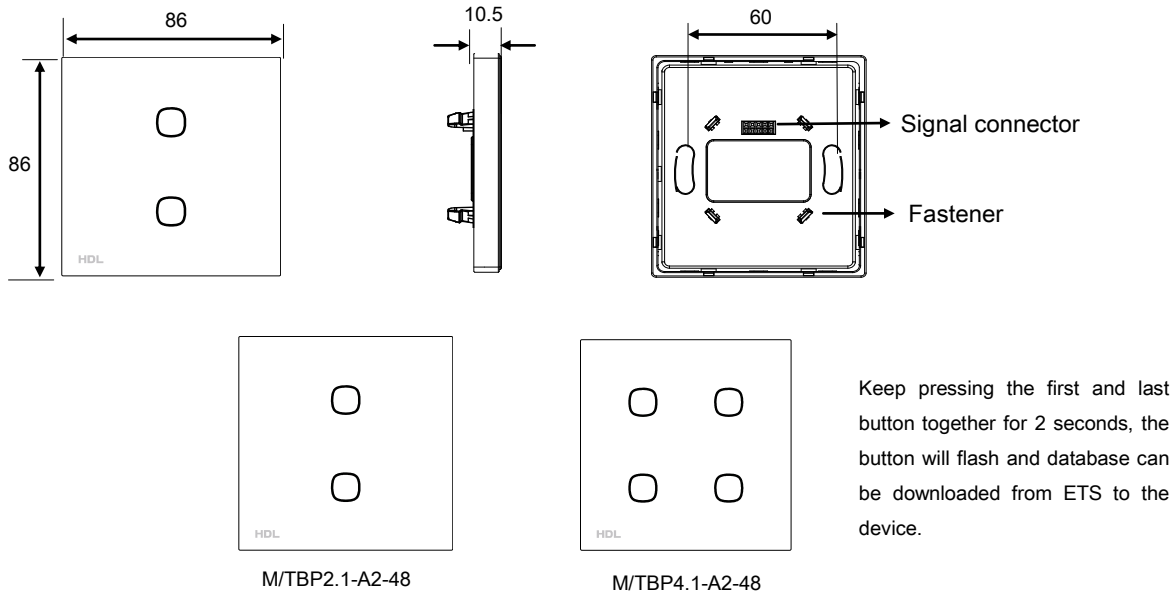

**Installation**

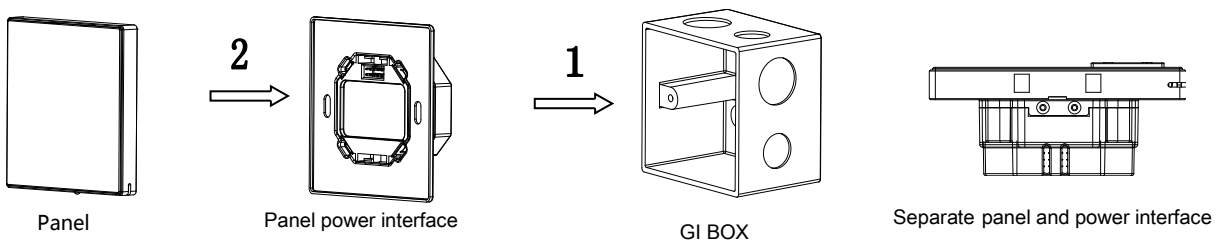

**Installation:** Hold the edge of panel, insert the power interface module vertically. Do not push the panel too hard.

**Split:** Panel and panel power interface by magnetic suction, you can split them apart directly.

**Safety Precautions**

- Installation Position: indoor.
- Do not make wrong connection on Bus interface, it will damage the Bus interface this module.
- Do not get AC220V voltage into KNX/EIB Bus wire , it will damage all of devices in system.
- Assure a good ventilation circumstances.
- Rain, liquid, and aggressive gas are not allowed to close to it.

**Package Contents**

- Datasheet\*1 / Panel \*1